

THIS INFORMATION IS CONFIDENTIAL AND IS DISCLOSED TO YOU ON CONDITION THAT NO FURTHER DISCLOSURE IS MADE BY YOU TO OTHER THAN TOP-LINK PERSONNEL WITHOUT WRITTEN AUTHORIZATION FROM TOP-LINK LTD.

DWG NO.
C-101390

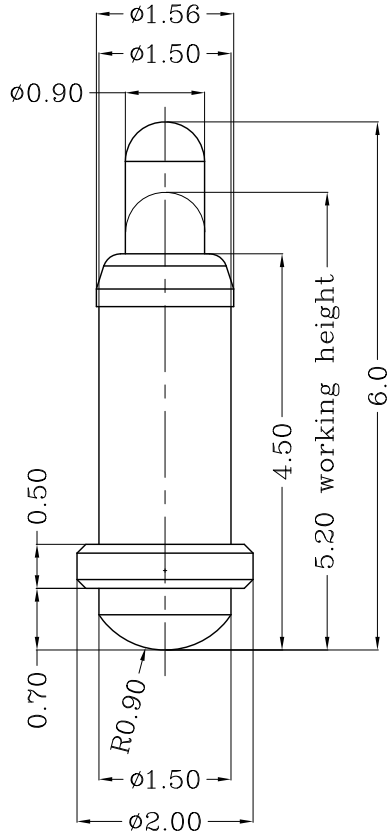

USED ON

-

Notes:



Material(材质):

- 1)Body : C36000
- 2)Plunge : C36000 or C27000
- 3)Spring : Stainless steel wire

2 Plating(电镀):

- 1)Body: Min 0.1um Gold plating over min. 1.4um Nickel plating (Body: 镀金0.1um Min 镍底1.4um Min)
- 2)Plunger: Min 0.4um Gold plating over min. 1.4um Nickel plating (Plunger: 镀金0.4um Min 镍底1.4um Min)

3 Mechanical(机械性能):

- 1)Force: 100±30gf per pin at 0.8mm stroke (力: 下压0.8mm的力: 100±30gf)
- 2)Total stroke(总行程) : 1.40mm
- 3)Durability(寿命): 10,000 cycle min.

4 Electrical(电性能)

- 1>Contact resistance(接触抵抗): 30mOhm Max.
- 2)Voltage rating(额定电压): 36V DC Max
- 3)Current rating(额定电流): 2.0A

LDC
-
DIST
-

LTR	NEW	APVD	2009/11/25
REVISION RECORD			

DIMENSIONS IN MM
TOLERANCES UNLESS
OTHER SPECIFIED
0 = ±-
0.0 = ±0.15
0.00 = ±0.10
0.000 = ±
ANGLE: ±1°
SURF TEXTURE: 3.2/
REMOVE BURRS. BREAK
SHARP EDGES R0.05 MAX
DO NOT SCALE PRINT

MATL	1	HT TR	-	FIN	-
DWN	Qin	APVD		Top-Link Electronics Ltd.	
CHK		REL			
NAME	POGO PIN PG-1.5-0.7-2.0-0.5-1.5-4.5-6.0				
SCALE	1:1	A4	DWG NO.	C-101390	SHEET 1 OF 1
					REV A

101390-1

PART NUMBER

4

3

2

1