

THIS INFORMATION IS CONFIDENTIAL AND IS DISCLOSED TO YOU ON CONDITION THAT NO FURTHER DISCLOSURE IS MADE BY YOU TO OTHER THAN TOP-LINK PERSONNEL WITHOUT WRITTEN AUTHORIZATION FROM TOP-LINK LTD.

DWG No.: C-101593

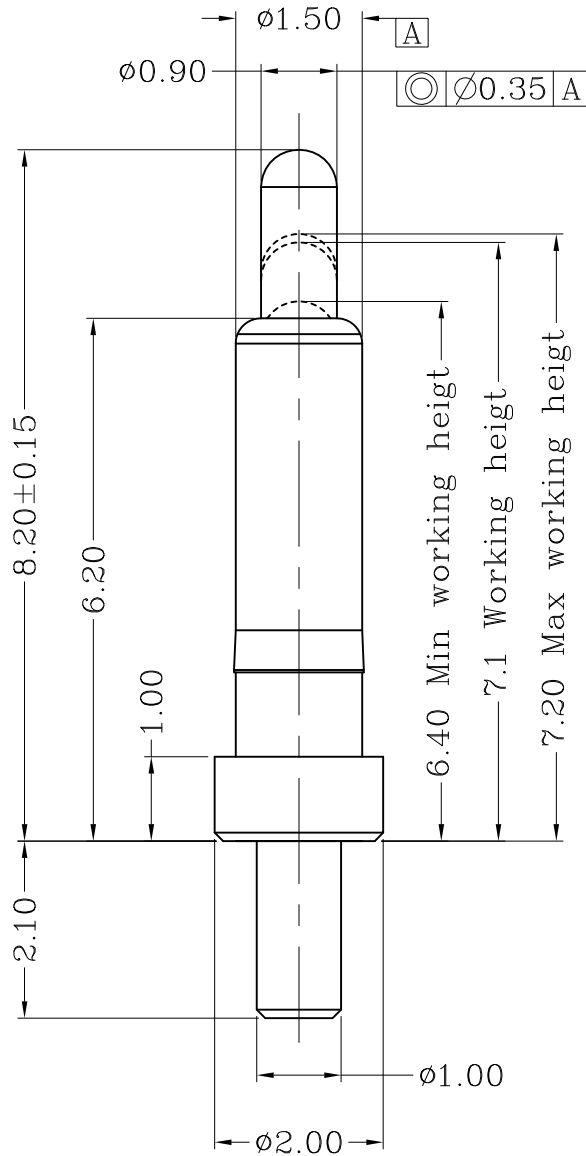

proposal



DIST

DIST

| | | |
|------|------------------|------------|
| A | Update | 2015/12/26 |
| 1 | NEW | 2012/02/20 |
| Rev. | Revision record. | Date. |

Top-Link
Electronics Ltd.
TOLERANCES UNLESS
OTHER SPECIFIED
0.0 = ± 0.15
0.00 = ± 0.10
0.000 = ± 0.05
Angle: ± 0.5°
SURF TEXTURE:
REMOVE BURRS.
BREAK SHARP EDGES
R0.05 MAX.DO NOT
SCALE PRINT.

| | | |
|--------------------------|------------|---------------------|
| Type Customer drawing | Unit mm | Weight |
| DWN: Cai wanlu | APVD: | |
| CHK: | REL: | |
| Name POGO PIN | | |
| Scale 1:1 | Size A4 | DWG No. C-101593 |
| Page 1/1 | Rev. A | |

| Item | Part name | Q'ty/Ea' | Material | Finish |
|------|-----------|----------|----------------------|---------------------------|
| 1 | Body | 1 | Leaded Brass | Au 0.1um plating Ni 1.4um |
| 2 | Plunger | 1 | Leaded Brass | Au 0.4um plating Ni 1.4um |
| 3 | Spring | 1 | Stainless steel wire | |
| 4 | | | | |
| 5 | | | | |

| Table 1 Mechanical performance | | |
|--------------------------------|------------|----------------|
| Working height | 7.10mm | 100±20gf <2.1> |
| Durability | 10000cycle | |

Notes:

- Dimensions shall be interpreted per ASME Y14.5M.
- Mechanical performance(See the table 1)
<2.1>The force is the average of forces obtained when plunger goes downwards and upwards.
<2.2>Warning:Working height are not permitted to be less than Min working height.
- Electrical performance
Resistance: 30mOhm Max.
Current rating: 2.0A
- RoHS compliant.

101593-1
PART NUMBER

top-Link
Electronics
Top-Link
Electronics Ltd.