



proposal

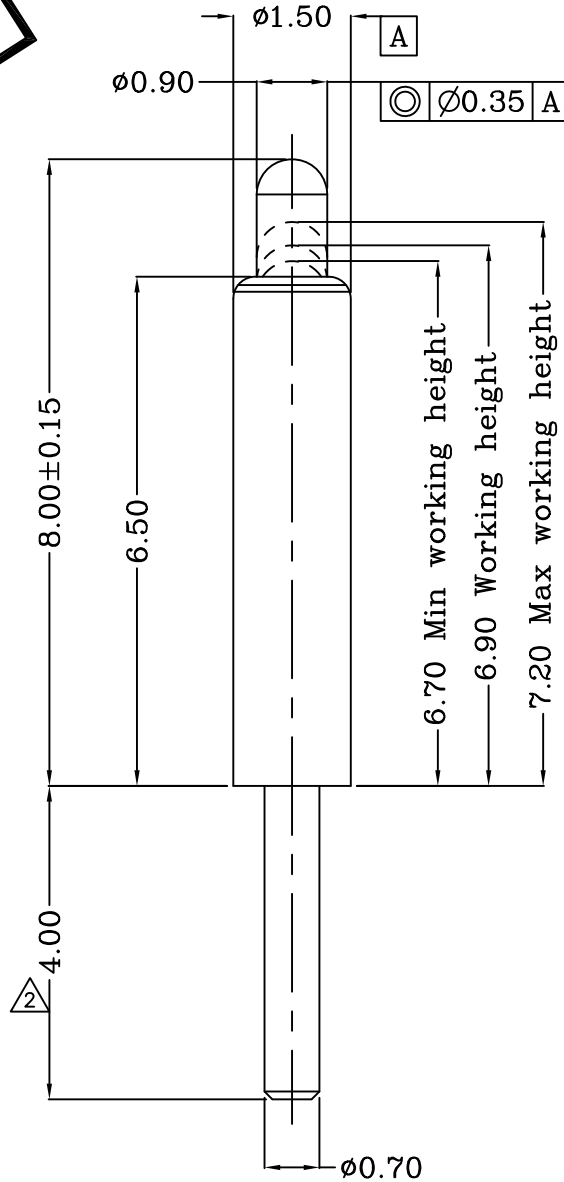

Table 1 Mechanical performance		
working height	6.90mm	120±35gf <2.1>
Durability	10000cycle	

Notes:

1 Dimensions shall be interpreted per ASME Y14.5M.

2 Mechanical performance(See the table 1)

<2.1>The force is the average of forces obtained when plunger goes downwards and upwards.

<2.2>Warning:Working height are not permitted to be less than Min working height.

3 Electrical performance

Resistance: 30mOhm Max.

Current rating: 2.0A

4 RoHS compliant.

Item	Part name	Q'ty/Ea'	Material	Finish
1	Body	1	Leaded Brass	Au 0.1um plating Ni 1.4um
2	Plunger	1	Leaded Brass	Au 0.4um plating Ni 1.4um
3	Spring	1	Stainless steel wire	—————
4				
5				

DIST  
---

DIST  
---

2	Update	2015/11/05
1	NEW	2015/10/22
Rev.	Revision record.	Date.

Top-Link Electronics Ltd.		Type Customer drawing	Unit mm	Weight _____	
TOLERANCES UNLESS OTHER SPECIFIED		DWN: Cai wanlu	APVD:	<div>top-Link Electronics</div> <div>Top-Link Electronics Ltd.</div>	
0. = ± -		CHK:	REL:		
0.0 = ± 0.15					
0.00 = ± 0.10					
0.000= ± -					
Angle: ±					
SURF TEXTURE: REMOVE BURRS.		Name POGO PIN			
BREAK SHARP EDGES		Scale 1: 1	Size A4	DWG No. C-20101011277	Page 1/1
R0.05 MAX.DO NOT SCALE PRINT.					Rev. 2

20101011277  
PART NUMBER